



TimbersBliss

TimbersBliss high-quality wooden solutions for your garden!

Our selection includes products for every taste – stylish garden houses, cozy sauna houses, children's playhouses and garages.

Our products are made of high-quality wood and handcrafted, taking into account the wishes and capabilities of the customer. We can manufacture products for export according to the market needs and requirements of your country.

One of our main differences compared to others may be that we can offer our customers special solutions both in the form of existing products and completely according to your standards. In other words, you can order a product from us based on your drawing and sketch.





TimbersBliss

Aiden Garden house with a window (20m²)

- exterior dimensions: 500 cm x 400 cm
- walls are made of 44 mm thick spruce
- ceiling and floor are made of 18 mm thick spruce
- lockable double door with insulated glazing, dimensions 1,300 x 1,900 (fully wood-covered door is optional)
- openable window with insulated glazing, dimensions 765 x 818
- all the screws and nails required for assembly are included
- assembly instructions

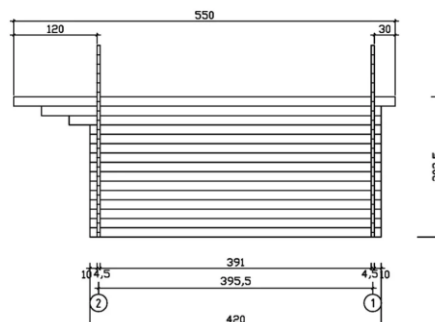
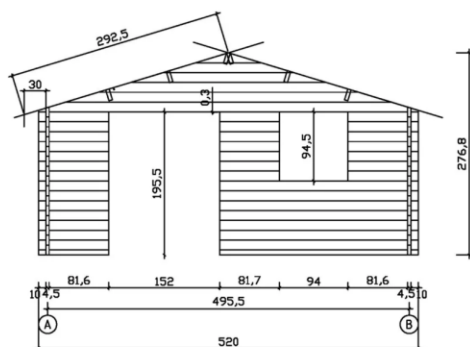
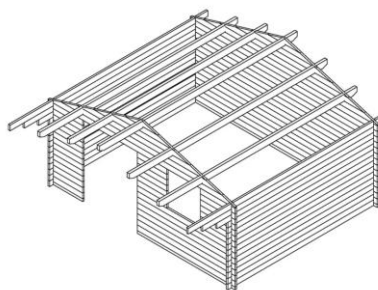



TimbersBliss

Amelia Garden house 40cm with a step (13,4m²)

- exterior dimensions: 480 cm x 280 cm
- walls are made of 44 mm thick spruce
- ceiling and floor are made of 18 mm thick spruce
- terrace board 28 mm x 120 mm
- lockable double door with insulated glazing, dimensions 1,300 x 1,900 (fully wood-covered door is optional)
- lockable door with insulated glazing, dimensions 905 x 1,900 (fully wood-covered door is optional)
- two openable windows with insulated glazing, dimensions 765 x 818
- all the screws and nails required for assembly are included
- assembly instructions

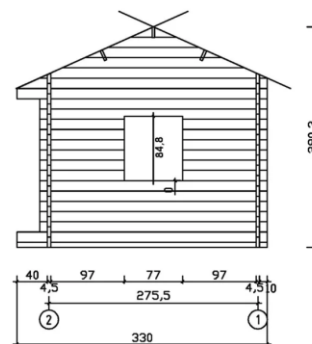
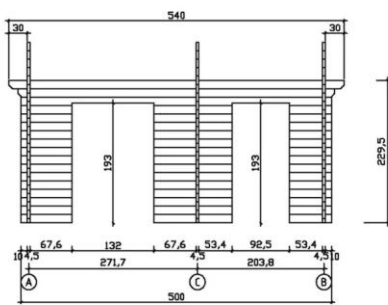
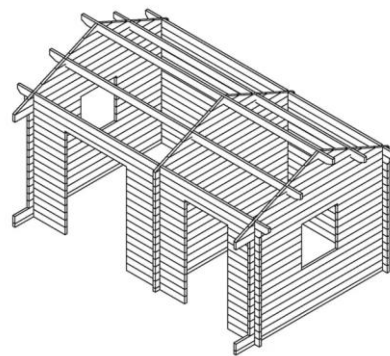



TimbersBliss

Caleb Garden house 13- four windows, 68mm thick wood (15,81m2)

- exterior dimensions: 309.5 cm x 509.5 cm
- walls are made of 68 mm thick spruce
- ceiling and floor are made of 18 mm thick spruce
- two lockable doors with insulated glazing, dimensions 905 x 1,900 (fully wood-covered door is optional)
- two openable windows with insulated glazing in front, dimensions 900 x 1,200
- two openable windows with insulated glazing in side walls, dimensions 900 x 600 and 600 x 1,200
- all the screws and nails required for assembly are included
- assembly instructions

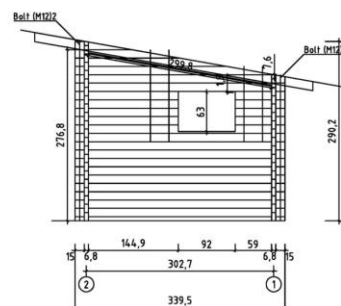
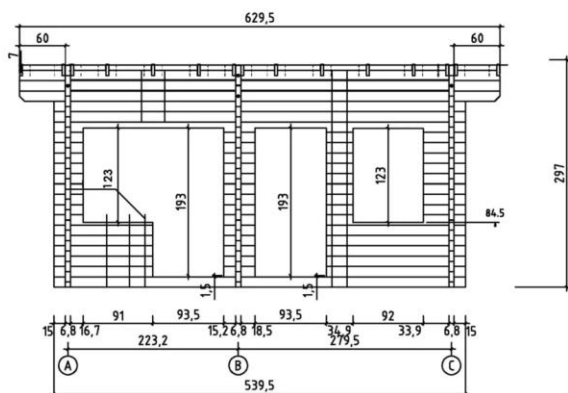
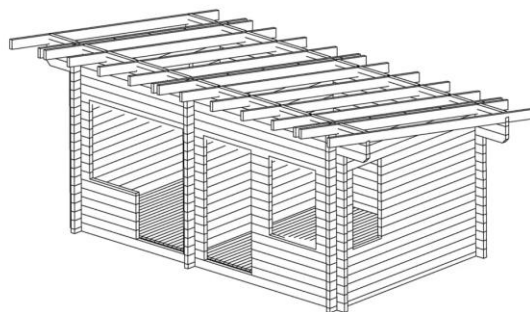



TimbersBliss

Celeste Garden house with a pitched roof (19,2m²)

- exterior dimensions: 480 cm x 400 cm
- walls are made of 44 mm thick spruce
- ceiling and floor are made of 18 mm thick spruce
- lockable door with insulated glazing, dimensions 905 x 1,900 (fully wood-covered door is optional)
- window with insulated glazing, dimensions 2,500 x 1,200
- window with insulated glazing in side wall, dimensions 500 x 1,590
- all the screws and nails required for assembly are included
- assembly instructions

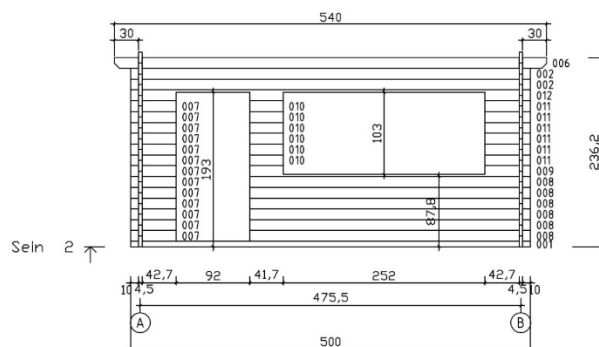
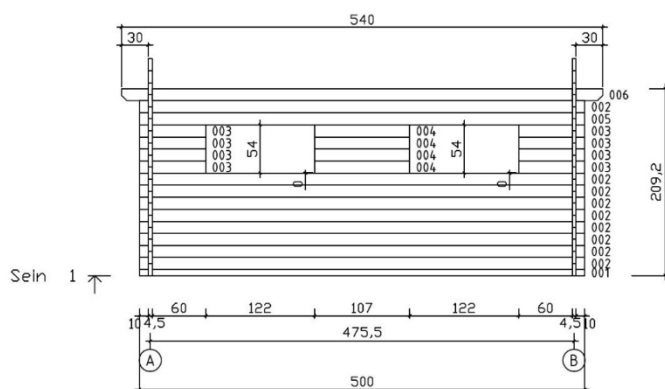
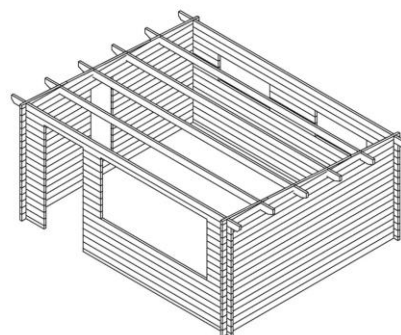



TimbersBliss

Chloe Garden house, one room (8,6m²)

- exterior dimensions: 309 cm x 279 cm
- walls are made of 44 mm thick spruce
- ceiling and floor are made of 18 mm thick spruce
- lockable door with insulated glazing, dimensions 905 x 1,900 (fully wood-covered door is optional)
- openable window with insulated glazing, dimensions 765 x 818
- all the screws and nails required for assembly are included
- assembly instructions

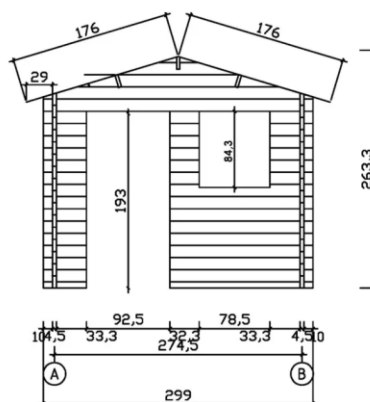
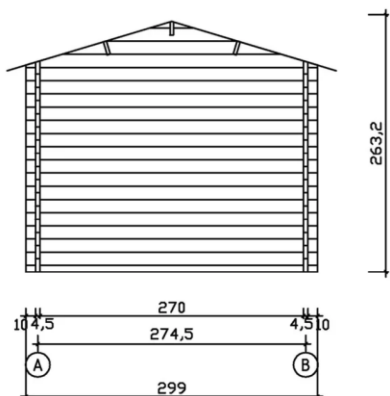
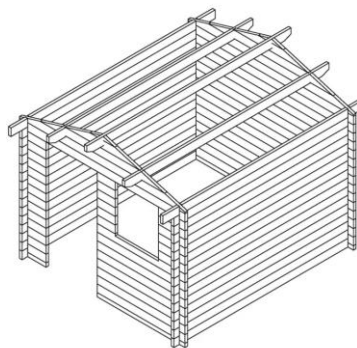



- exterior dimensions: 434.5 cm x 330 cm
- walls are made of 44 mm thick spruce
- ceiling and floor are made of 18 mm thick spruce
- two lockable doors with insulated glazing: exterior door with the dimensions of 905 x 1,900, inner door 80 x 200 (fully wood-covered door is optional)
- openable window with insulated glazing, dimensions 765 x 818
- all the screws and nails required for assembly are included
- assembly instructions

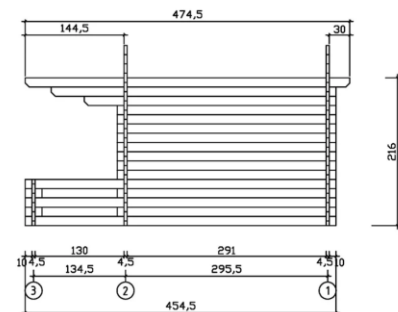
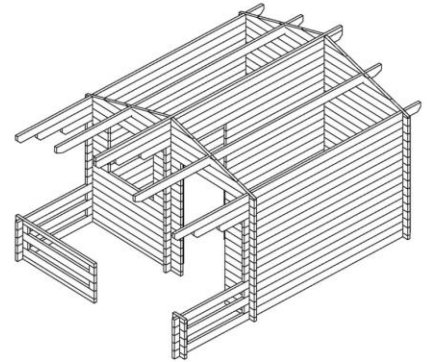



TimbersBliss

Atlas Garden Sauna (4.7m²)

- external dimensions: 270 cm x 180 cm
- walls made of 44 mm thick spruce
- ceiling made of 18 mm thick spruce
- lockable double-glazed door measuring 905 x 1900, (full-panel door possible)
- two-step sauna platform made of spruce
- all the screws and nails required for assembly are included
- assembly instructions

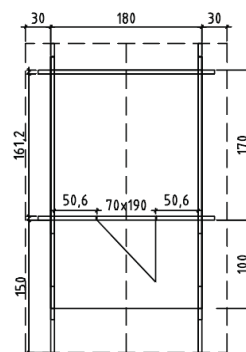
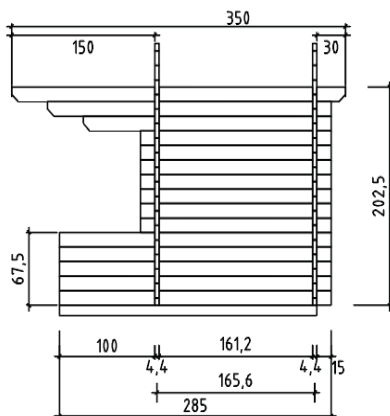
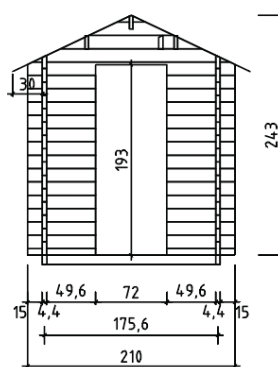



TimbersBliss

Jasper Garden Shed (7.5m²)

- external dimensions: 2.5 × 3.0
- walls made of 44 mm thick spruce
- door 80 x 172
- assembly instructions

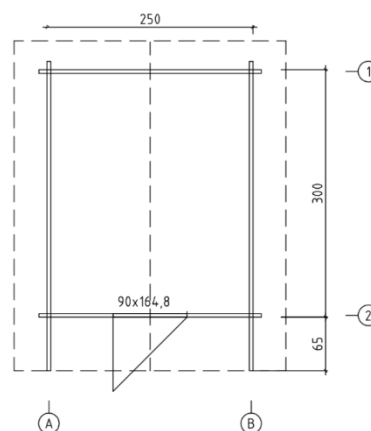
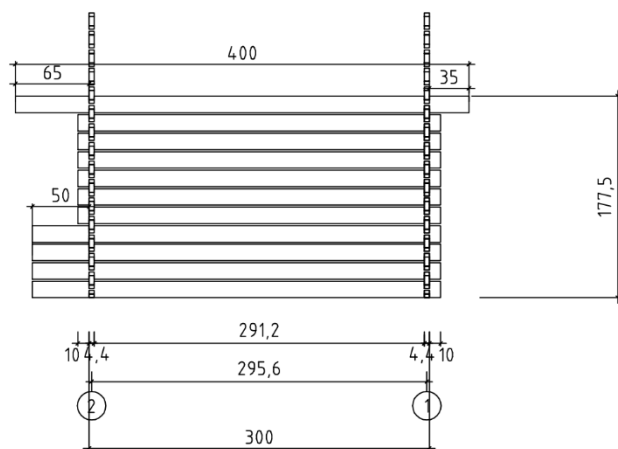
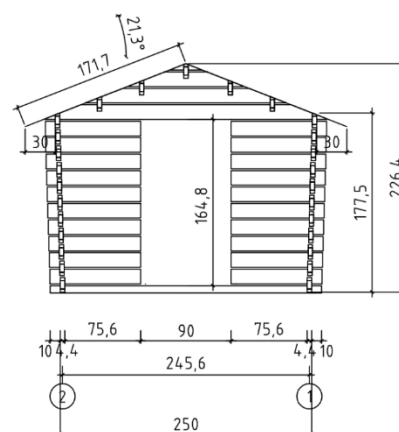



TimbersBliss

Julian Garden house 70cm terrace, 68mm thick wood (12,64m²)

- exterior dimensions: 397 cm x 480 cm
- walls are made of 68 mm thick spruce
- ceiling and floor are made of 18 mm thick spruce
- terrace board 28 mm x 120 mm
- terrace with railings
- lockable double door with insulated glazing, dimensions 1,300 x 1,900 (fully wood-covered door is optional)
- lockable door with insulated glazing, dimensions 905 x 1,900 (fully wood-covered door is optional)
- two openable windows with insulated glazing, dimensions 765 x 818
- all the screws and nails required for assembly are included
- assembly instructions

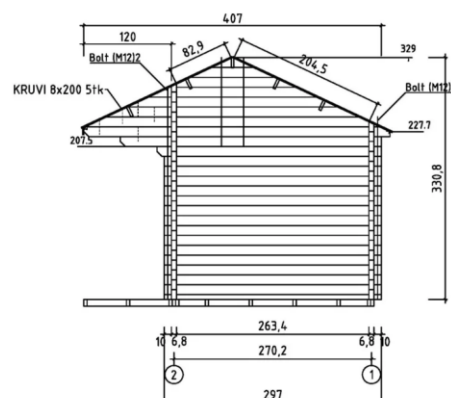
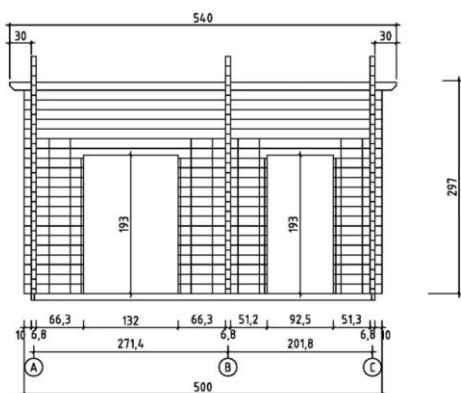
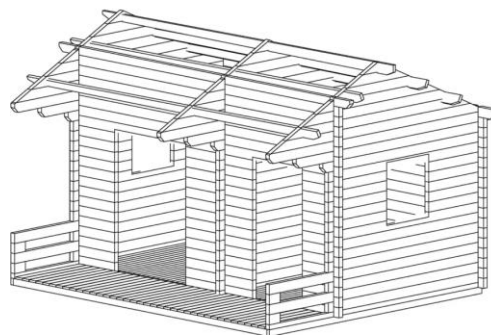



TimbersBliss

Liam Garden house 70cm with terrace (12,82m²)

- exterior dimensions: 480 cm x 346 cm
- walls are made of 44 mm thick spruce
- ceiling and floor are made of 18 mm thick spruce
- terrace board 28 mm x 120 mm
- glass wall with the dimensions of 4,000 x 2,050, including the door with the dimensions of 800 x 2,050
- two openable packet windows measuring 1200 x 450
- two openable windows with insulated glazing, dimensions 1,200 x 450
- two hexagonal windows are designed for both sides NB! Holes will be cut on site after installation and positioned according to the buyer's preferences.
- all the screws and nails required for assembly are included
- assembly instructions

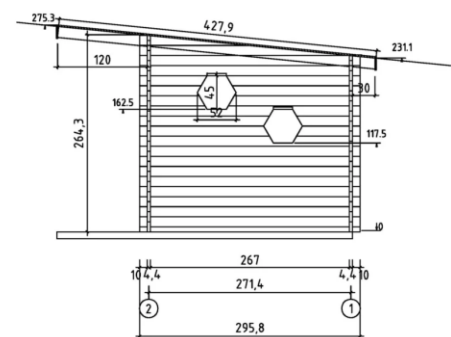
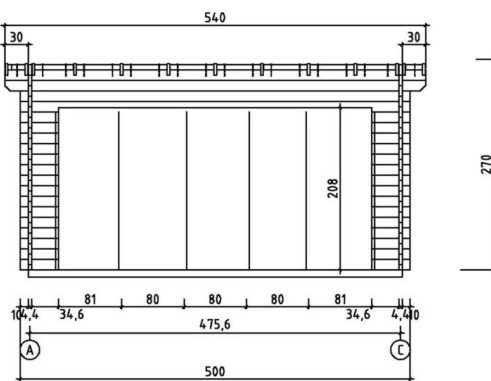
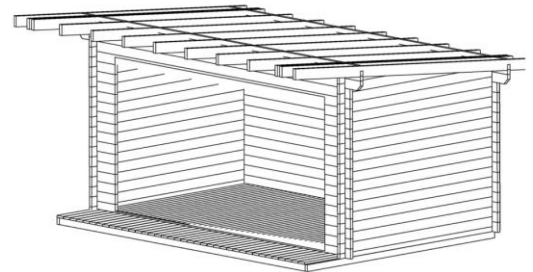



TimbersBliss

Lucas Wooden Shed (10.5m²)

- external dimensions: 3.5 × 3.0
- walls made of 44 mm thick spruce
- double door 160 x 165
- assembly instructions

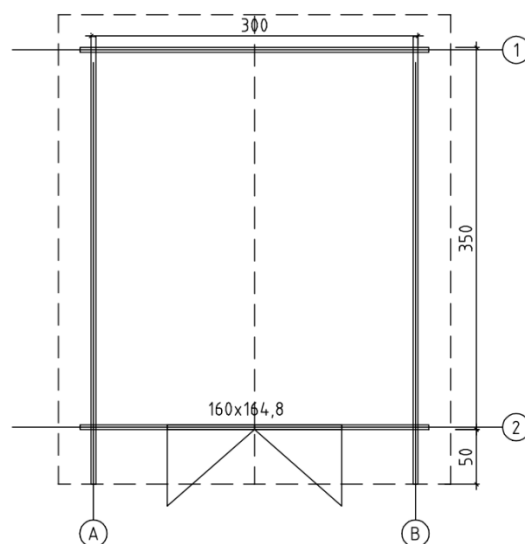
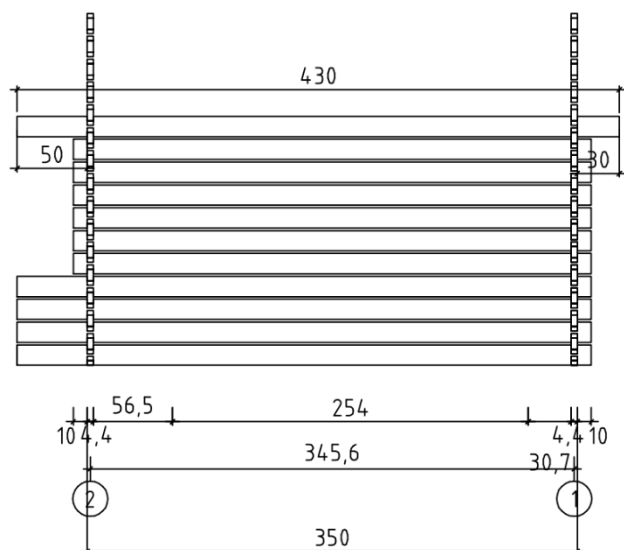
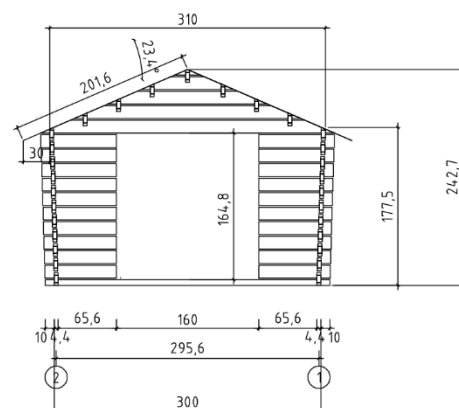



TimbersBliss

Luna Garden house with a window (9m²)

- exterior dimensions: 300 cm x 300 cm
- walls are made of 44 mm thick spruce
- ceiling and floor are made of 18 mm thick spruce
- lockable double door with insulated glazing, dimensions 1,300 x 1,900 (fully wood-covered door is optional)
- openable window with insulated glazing, dimensions 765 x 818
- all the screws and nails required for assembly are included
- assembly instructions

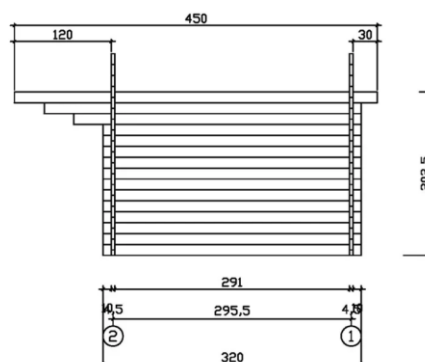
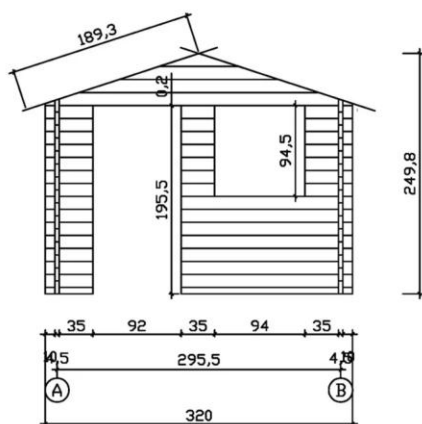
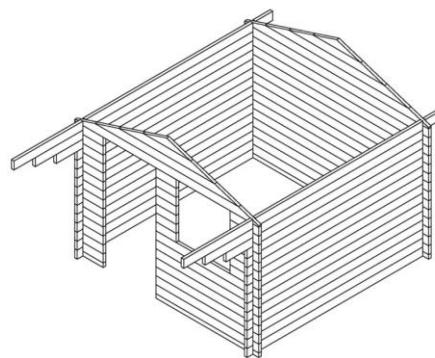



TimbersBliss

Nova Garden house 70cm with a canopy (6,25m²)

- exterior dimensions: 250 cm x 250 cm
- walls are made of 44 mm thick spruce
- ceiling and floor are made of 18 mm thick spruce
- lockable double door with insulated glazing, dimensions 1,300 x 1,900 (fully wood-covered door is optional)
- all the screws and nails required for assembly are included
- assembly instructions

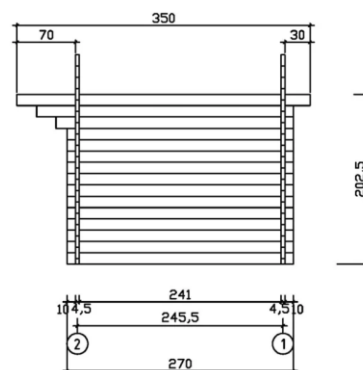
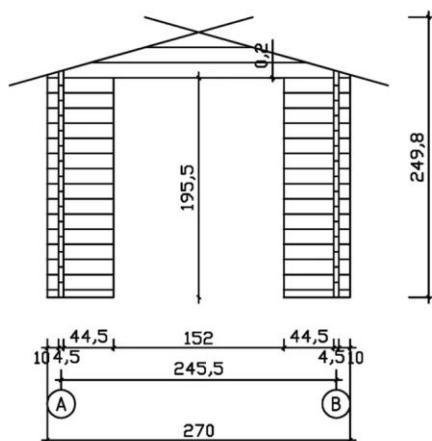
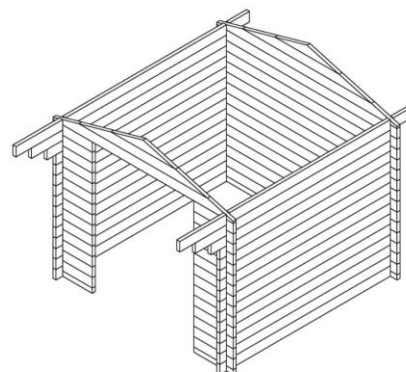



TimbersBliss

Olivia Garden house, two rooms (9,8m²)

- exterior dimensions: 415 cm x 235 cm
- walls are made of 44 mm thick spruce
- ceiling and floor are made of 18 mm thick spruce
- lockable double door with insulated glazing, dimensions 1,300 x 1,900 (fully wood-covered door is optional)
- lockable door, dimensions 905 x 1,900 (insulated glazing is optional)
- two openable windows with insulated glazing, 765 x 818
- all the screws and nails required for assembly are included
- assembly instructions

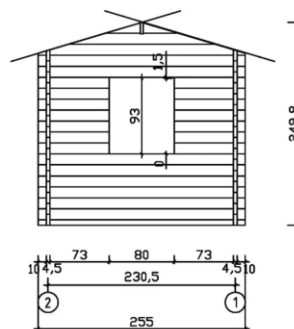
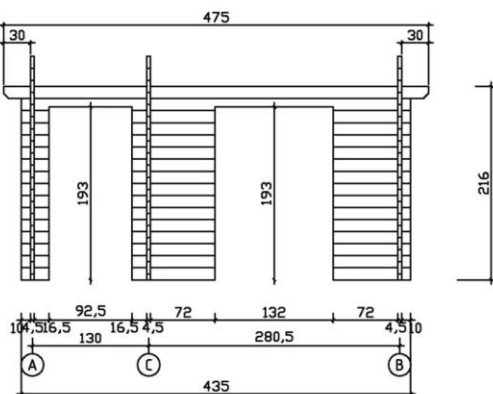
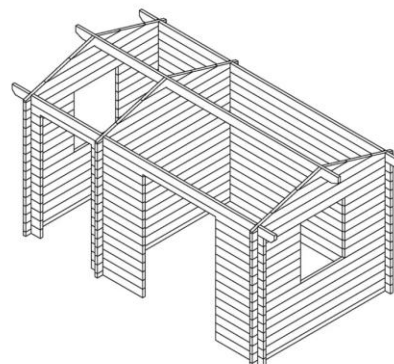



TimbersBliss

Titan Garden Sauna (11.9m2)

- external dimensions: 350 cm x 340 cm
- walls made of 44 mm thick spruce
- ceiling made of 18 mm thick spruce
- floor made of 28 mm thick spruce
- lockable double-glazed exterior door measuring 905 x 1900, interior door 80 x 1900 (full-panel door possible)
- opening double-glazed window measuring 90 x 70
- all the screws and nails required for assembly are included
- assembly instructions

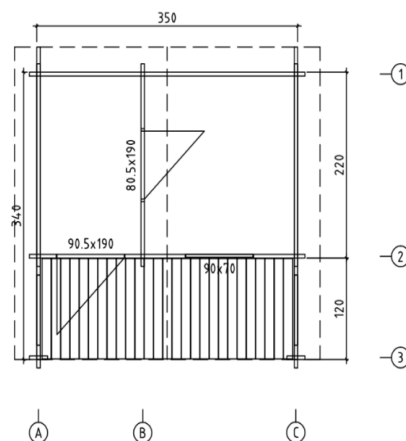
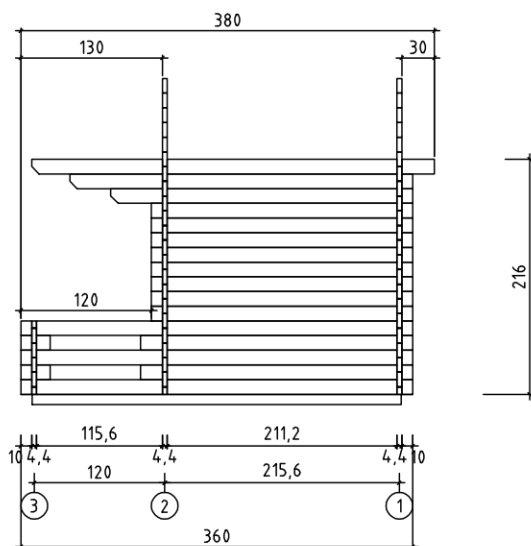
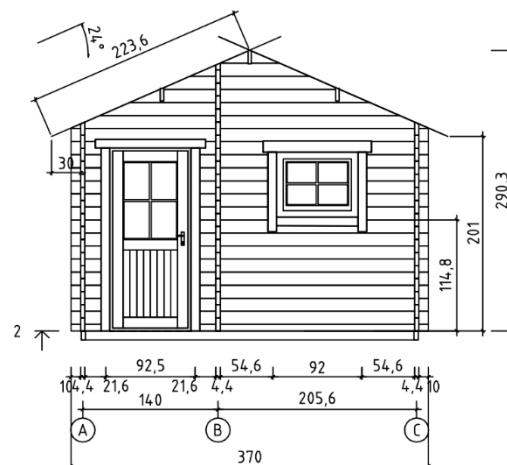



TimbersBliss

Scarlett Garden house with a window (7,5m²)

- exterior dimensions: 300 cm x 250 cm
- walls are made of 44 mm thick spruce
- ceiling and floor are made of 18 mm thick spruce
- lockable door with insulated glazing, dimensions 905 x 1,900 (fully wood-covered door is optional)
- openable window with insulated glazing, dimensions 765 x 818
- all the screws and nails required for assembly are included
- assembly instructions

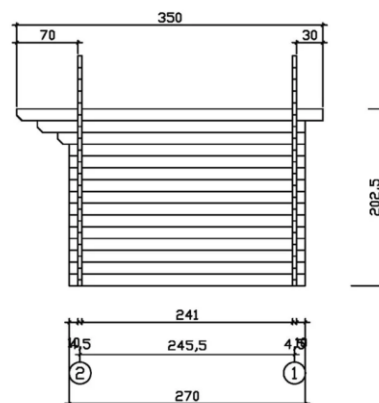
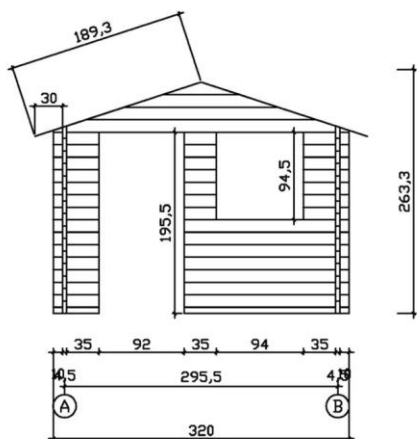
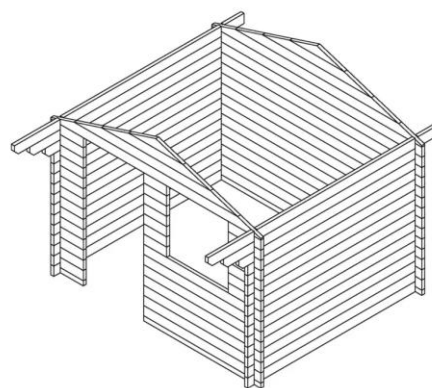



TimbersBliss

Sofia Garden house 70cm with terrace (13,4m²)

- exterior dimensions: 480 cm x 280 cm
- walls are made of 44 mm thick spruce
- ceiling and floor are made of 18 mm thick spruce
- terrace board 28 mm x 120 mm
- lockable double door with insulated glazing, dimensions 1,300 x 1,900 (fully wood-covered door is optional)
- lockable door with insulated glazing, dimensions 905 x 1,900 (fully wood-covered door is optional)
- two openable windows with insulated glazing, dimensions 765 x 818
- all the screws and nails required for assembly are included
- assembly instructions

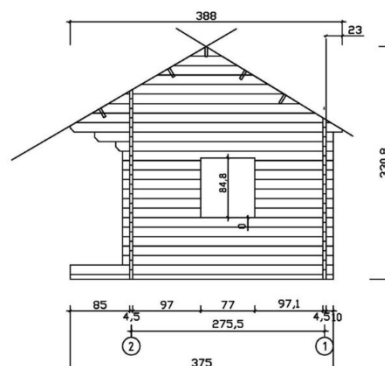
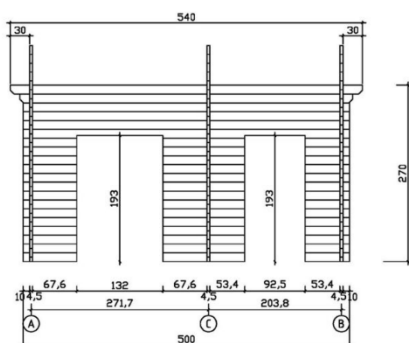
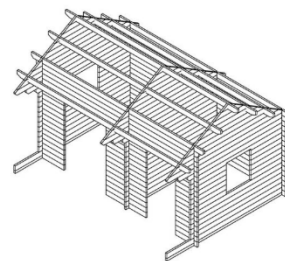



TimbersBliss

Willow Garden shed (5m2)

- external dimensions: 2.5 × 2.0
- walls made of 44 mm thick spruce
- door 80 x 172
- assembly instructions

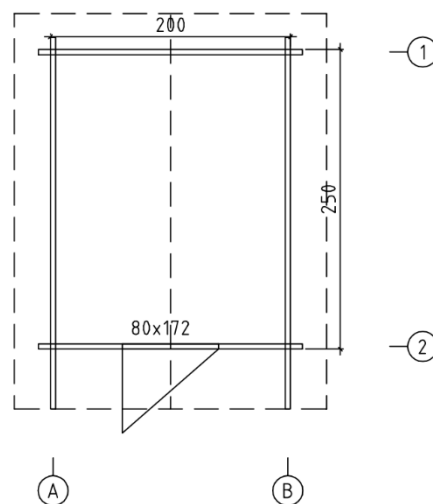
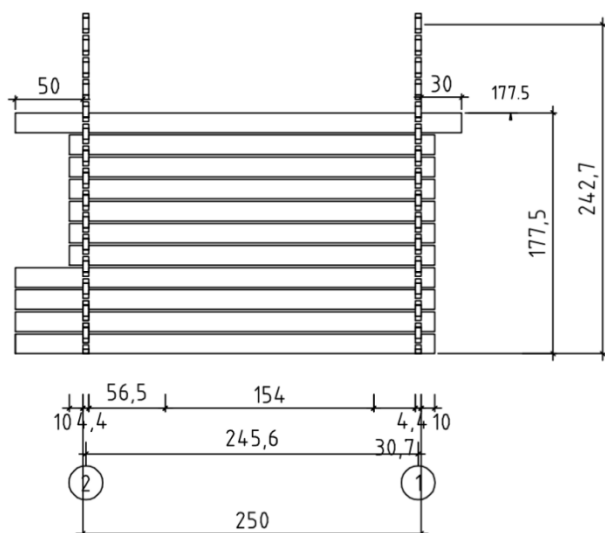
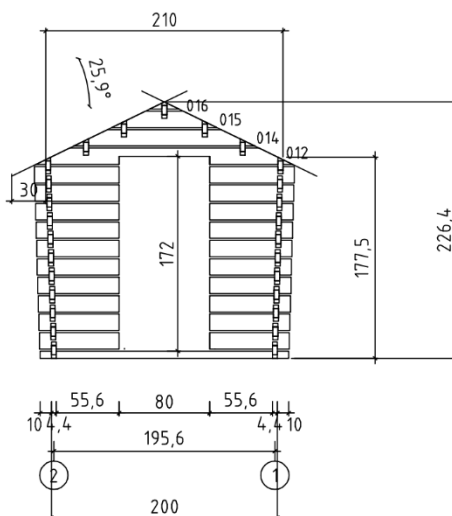



TimbersBliss

If you have questions or want to buy some of our products please feel free to let us know!

TimbersBliss OÜ

Address: Haapsalu mnt 57, Keila, Harjumaa, Estonia

Email: info@timbersbliss.ee

Website: www.timbersbliss.ee